

CORONA

- V I S I O N -

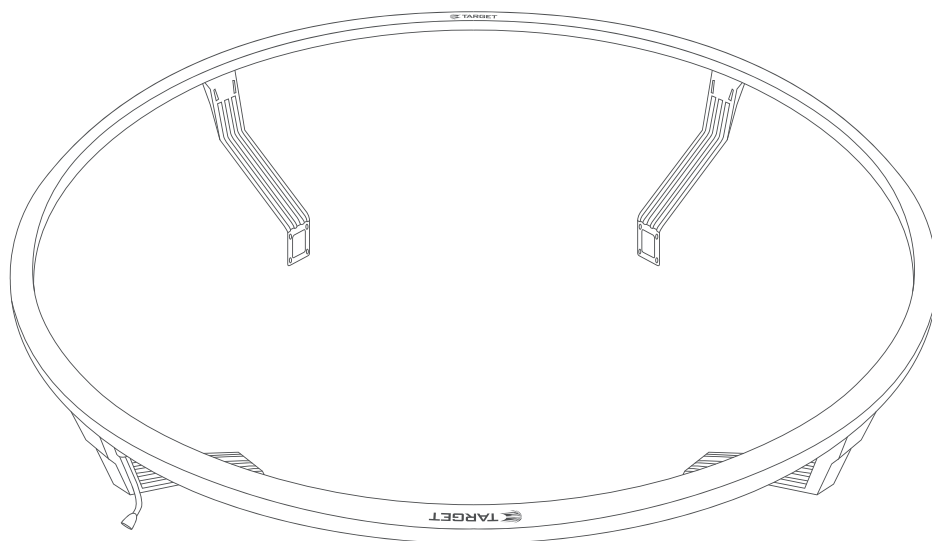

ASSEMBLY INSTRUCTIONS



TARGET

CONTENTS

- 1X LIGHT RING
- 2X LEGS W/ CABLE CLIP (LEG A)
- 2X LEGS (LEG B)
- 4X PLUG ADAPTERS
- 1X TRANSFORMER



TARGET

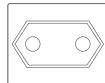
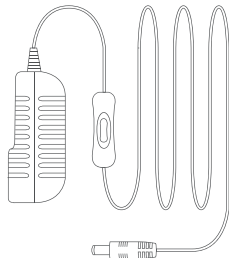

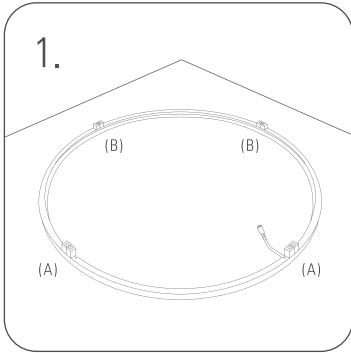

PLACE LIGHT RING
ON A FLAT SURFACE

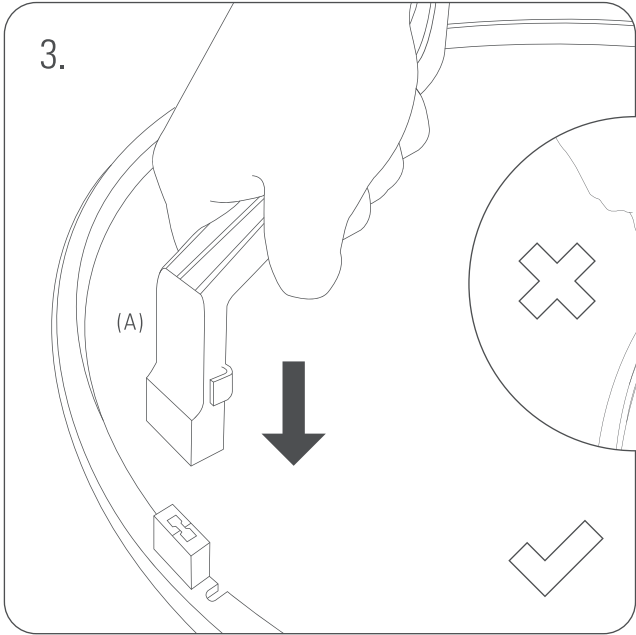
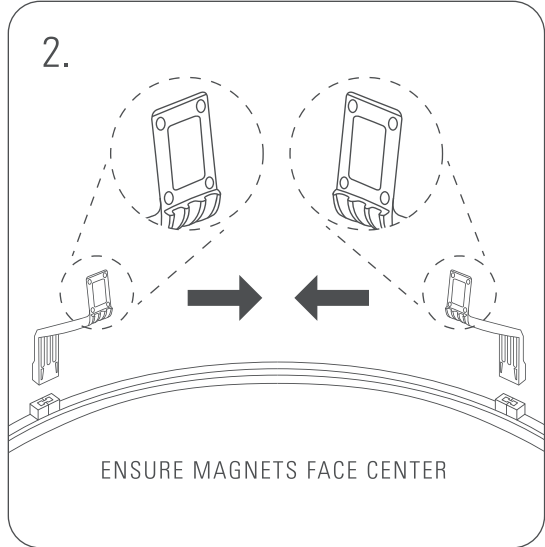

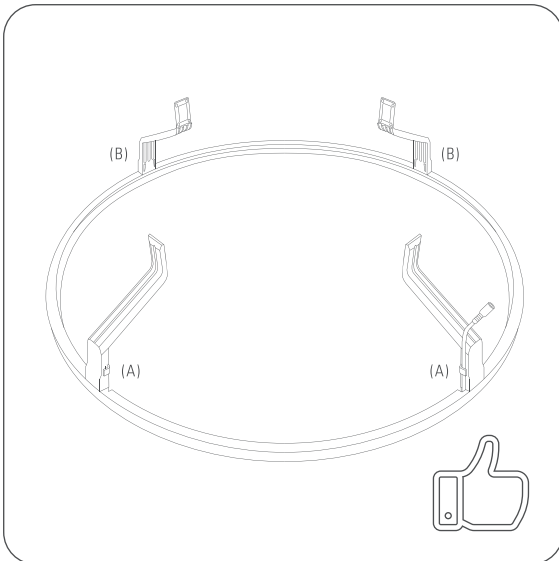
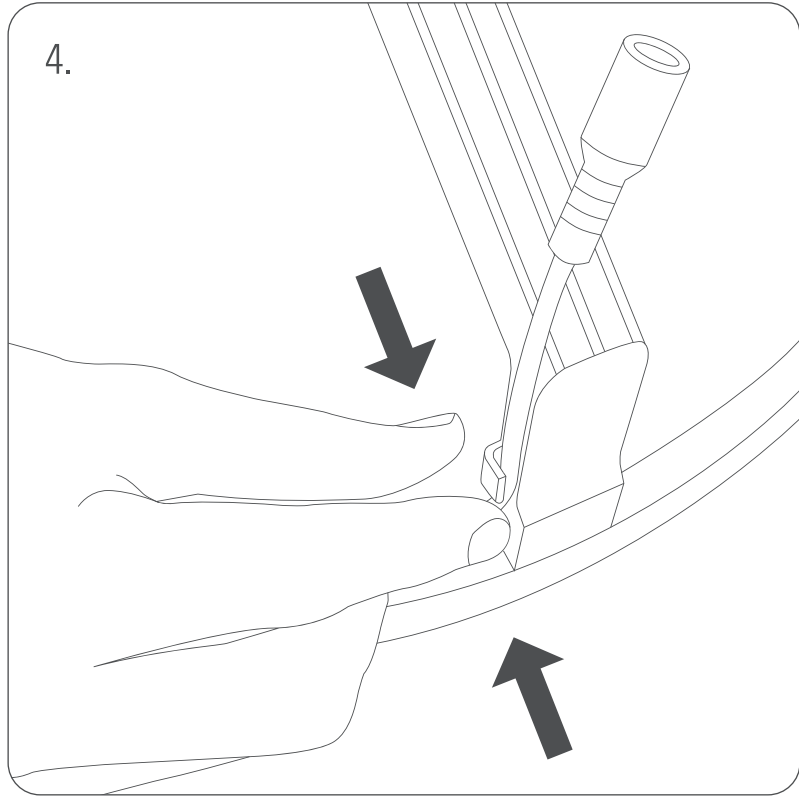

WARNING!

DO NOT ATTEMPT TO
REMOVE ONCE LOCKED

WAARSCHUWING!

PROBEER NIET TE
VERWIJDEREN WANNEER
EENMAAL GESLOTEN

ACHTUNG!

BITTE NICHT VERSUCHEN
ZU BEWEGEN WENN
GESCHLOSSEN

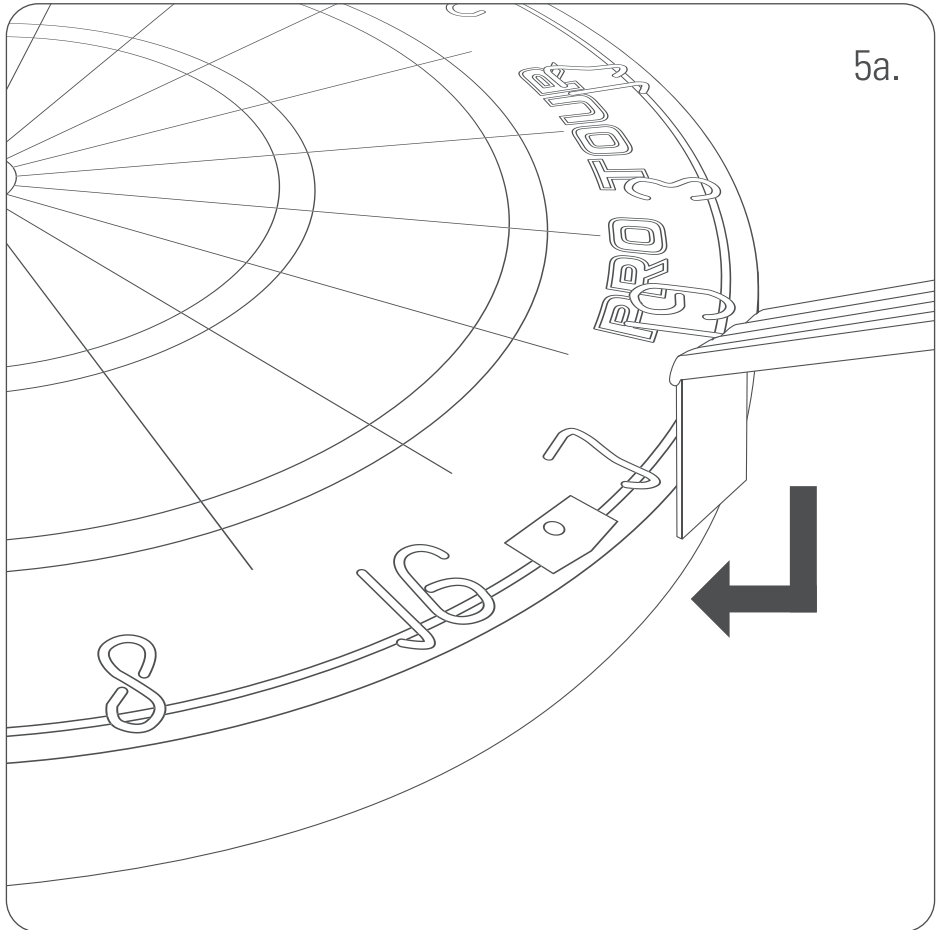
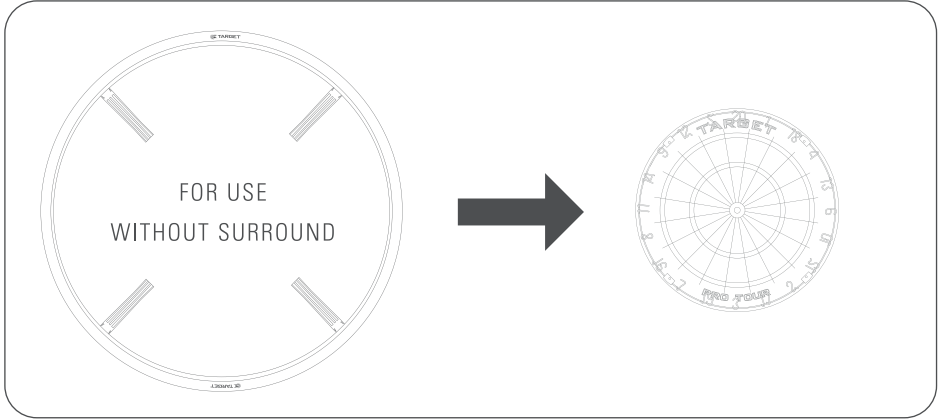

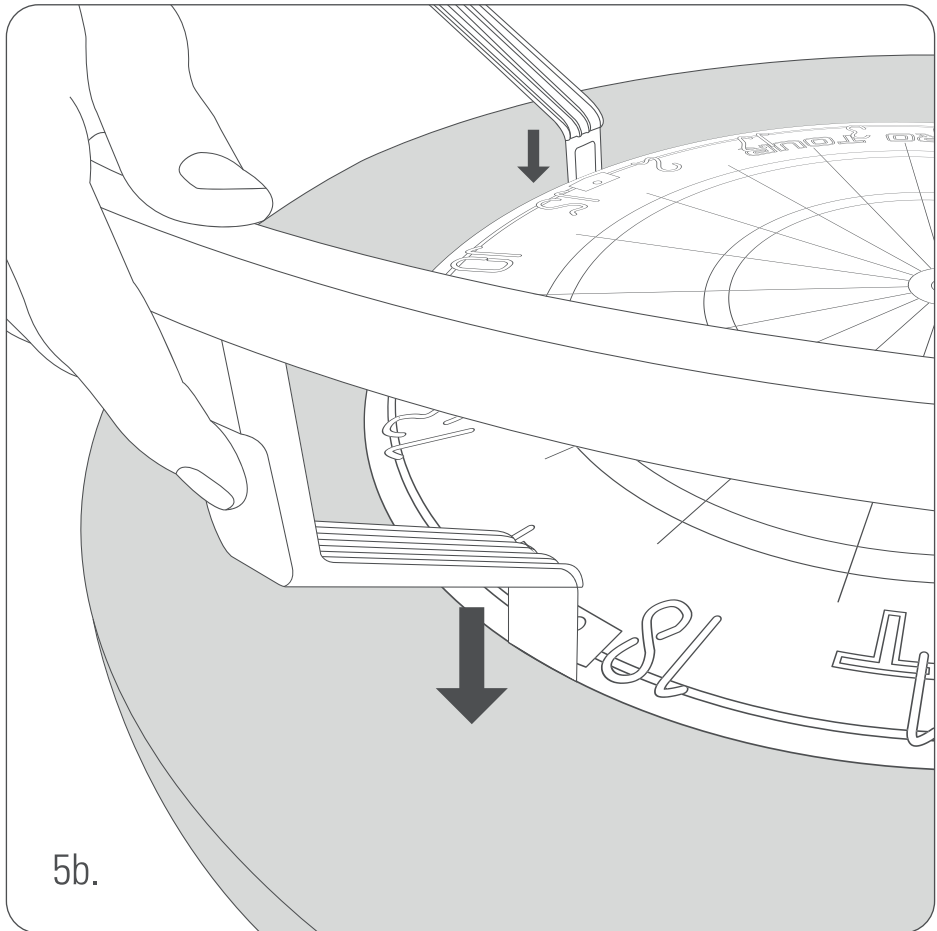
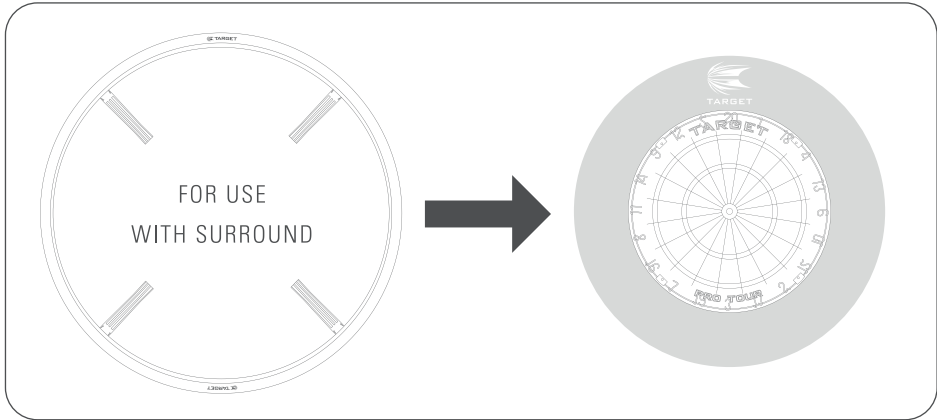

6.

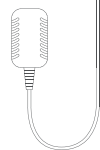
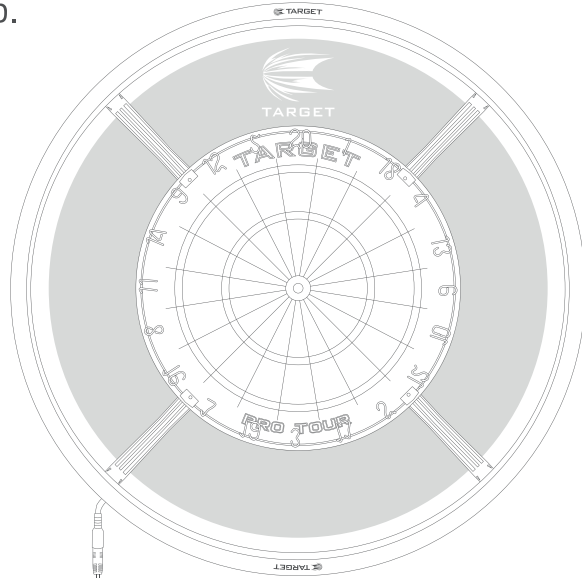



TARGET SPORTS LTD.
ELYSIAN HOUSE
LOVET ROAD
HARLOW
CM19 5TB
+44(0)1279 410155

INFO@TARGET-DARTS.CO.UK | WWW.TARGET-DARTS.CO.UK